

CELLULAR, IMT Omni Antenna

824~894, 1920~2170 MHz / 0 dBi

CI-SCAP-0S

i. Electrical Specification

Frequency Range	824~894, 1920~2170 MHz
Polarization	Omni
Band Width	70, 250 MHz
Gain	≥ 0 dBi
Beam Azimuth	Omni
Beam Elevation	8 Type
F-B ratio	-
IMD (2x30dBm)	-
VSWR	≤ 1 : 2
Impedance	50 Ω
Maximum input power	10 W

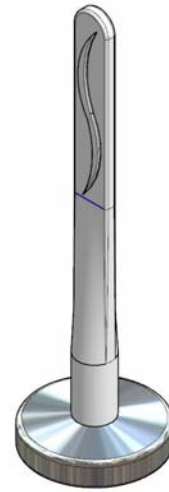

ii. Mechanical Specification

Radom Dimension (D x H)	Ø15 x 176 mm
Weight (Include bracket)	≤ 50 g
Connector Type	SMA Male / 1.5D-2V
Withstand Wind Pressure	60 m/sec
Radome Material	ASA,ABS
Radome Color	White
Temperature	-40 °C ~ 70 °C
Packing Size (H x W x D)	-
Packing Weight	-

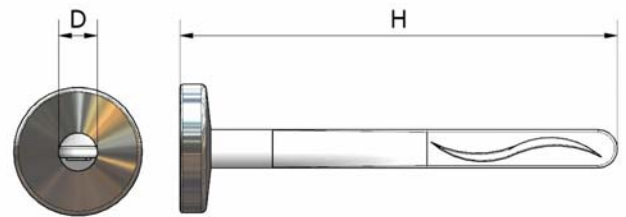

iii. Radiation Pattern

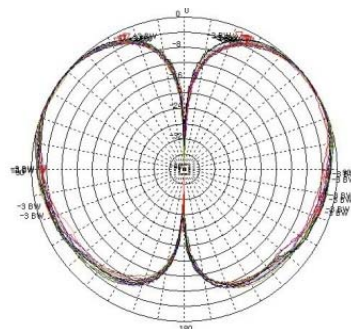

Vertical Pattern